

# CONTAINER HANDLING SYSTEMS

## TITAN CITY HOOKLOADER







# WELCOME TO HYVA

**Hyva Group is a leading global provider of innovative and highly efficient transport solutions for the commercial vehicle and environmental service industries.**

The company is committed to the development, production, marketing and distribution of components used in hydraulic loading and unloading systems on trucks and trailers.

Our products are used worldwide across a range of sectors including transport, construction, mining, materials handling and environmental services.

Hyva's portfolio comprises: Tipping Solutions (cylinders and tipping gear), Container Handling Systems (hookloaders and skiploaders), Waste Handling Systems (transfer stations, compactors and refuse collection bodies), Floors (horizontal unloading/loading floors) and Cranes (fixed and rolling).

**Hyva: Your Trusted Partner.**





## OUR COMPANY

**Founded in 1979 in The Netherlands, Hyva has significant manufacturing facilities in Brazil, China, Germany, India and Italy.**

Operating in more than 130 countries the company has more than 2,000 employees around the world, encompassing 39 subsidiaries and 13 production facilities.

Hyva products are now recognised as clear leaders in their fields. Our development engineers combine a unique blend of experience and expertise. They know what works, and what will still be working in 10 years time. Hyva products are fully certified to quality standards ISO9001:2008 & ISO14001:2004. A core part of Hyva's culture is to lead our industry by introducing new products with new ideas and new specifications.

Working closely with over 25,000 customers in 130 countries offers us a huge source of knowledge and experience - and hence a unique opportunity to continuously improve the products we offer. Our local application engineers understand all the various market and legal requirements, and are therefore your key advisors for optimum product selection.

Yet Hyva is much more than its products alone. Customer care is also fundamental. As a result, our Hyva Care programme provides a comprehensive range of after-sales support services.

**Hyva: The Complete Solution.**



# THE HYVA TITAN CITY

Engineered to go to every small corner of the world, the TITAN CITY is the best choice for operators and drivers alike.

- developed specifically for use with light commercial vehicles
- bringing TITAN boltable mounting to lighter hookloaders
- improved, higher performance steel structure

The well-known TITAN mounting has already won over many hearts and minds in the medium to heavy truck classes and is here to stay. The TITAN boltable mounting makes building the hookloader to a truck a breeze. This is further supported with chassis specific kits allowing for the best joining of truck and hookloader.









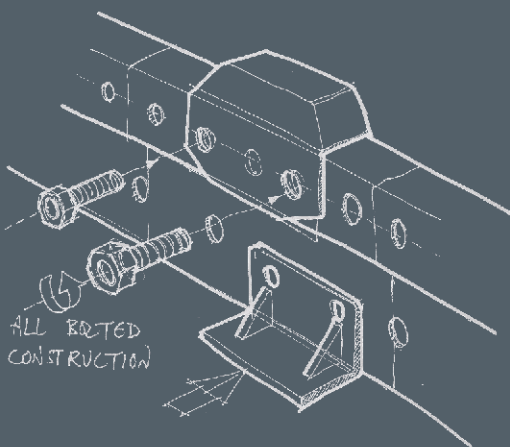

Pick-up hook

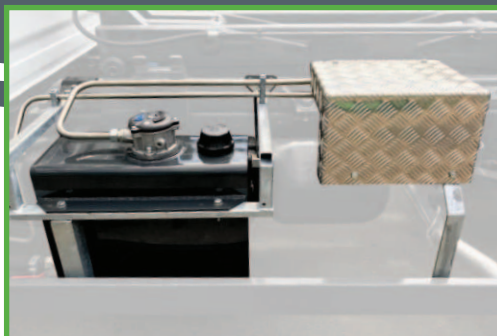

Tank + Valve



Main cylinder

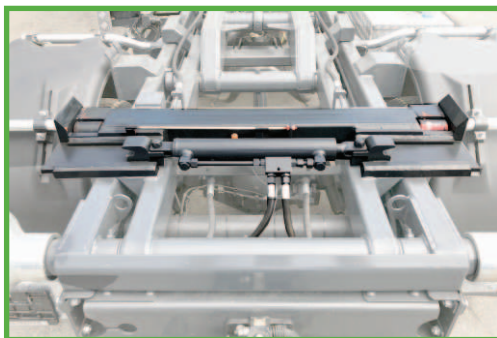

Hydraulic lock

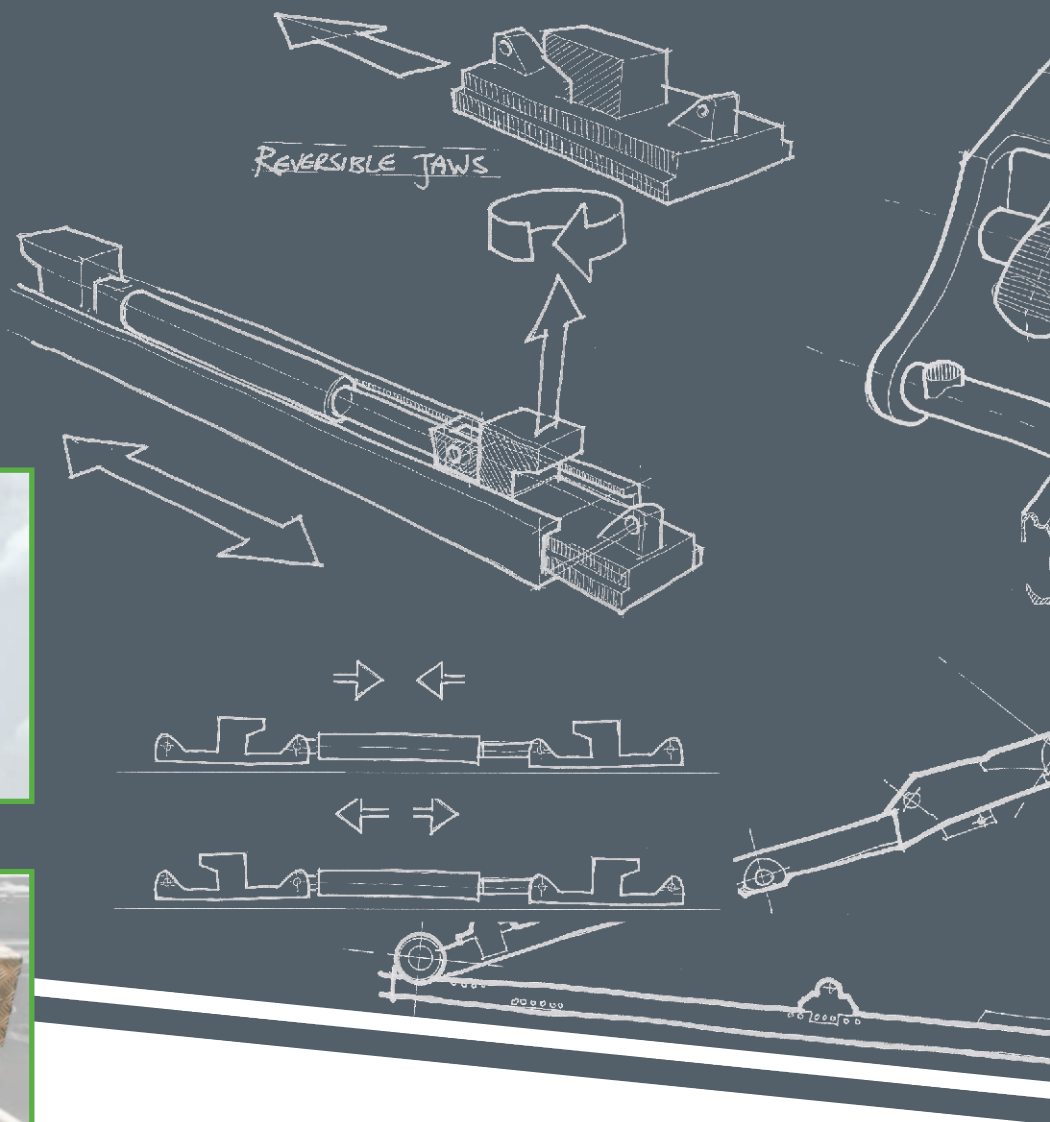

## RANGE PLAN

		SYSTEM LENGTH (M)											
		1,9	2,3	2,8	3,0	3,2	3,3	3,7	4,1	4,5	4,8	5,1	5,4
CAPACITY (TON)	1	K											
	3		K	K		K							
	4						S	S	S				
	5			K	S	K							
	6						S	S	S	S			
	8						S	S	S	S			
	10						S	S	S	S	S	S	S
S = Sliding hookloader													
K = Knuckle arm hookloader													

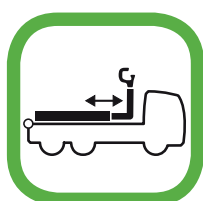
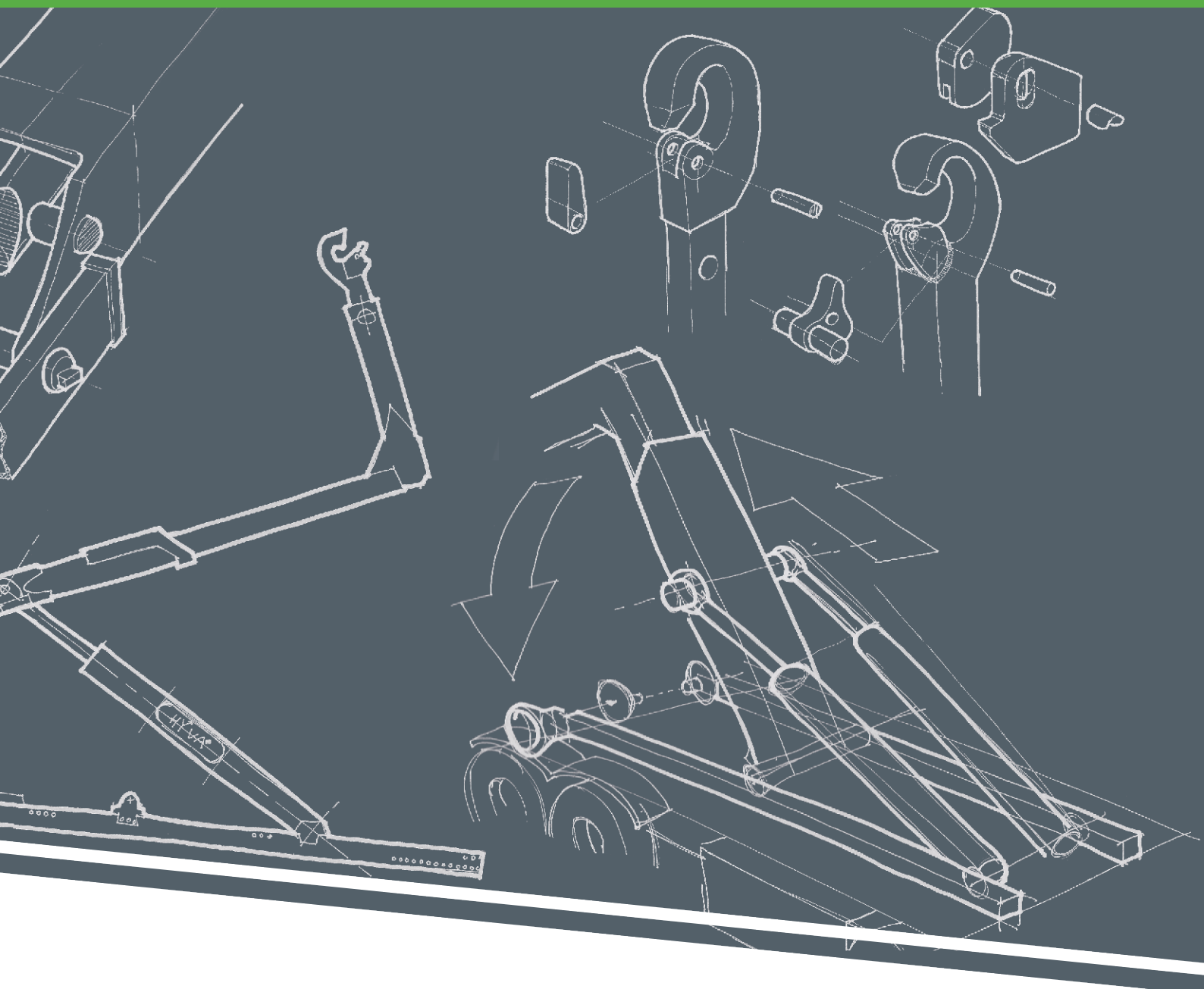

Sliding

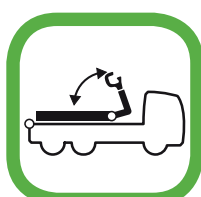
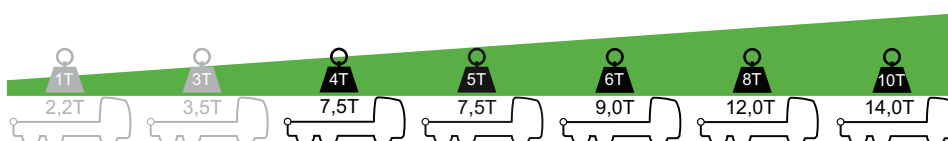

Knuckle

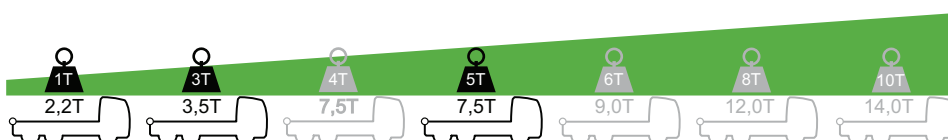

# TITAN CITY HOOKLOADER FEATURES

**EASY MOUNTING** The TITAN series offers an easy way of mounting. Joining the hookloader to the truck with a chassis specific mounting kit achieves repeatable quality time and time again. Hyva prides itself in creating chassis specific kits for every chassis.

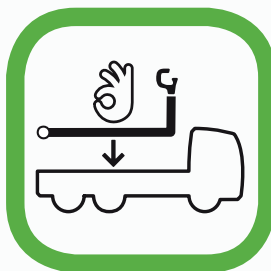

**CONTROL IT YOUR WAY** Select one of the many options for controlling your TITAN CITY. Select the operators' favourite pneumatic control or go with the more advanced electric system. We even offer control by Bowden cable putting your hands directly in touch with the flow.



**COMBI LOCK IT ALL** Fit your TITAN CITY with the combi-lock and gain the ability to lock every container to your system. Proven hydraulic locking securing your load every time. One lock for both outside and inside locking.

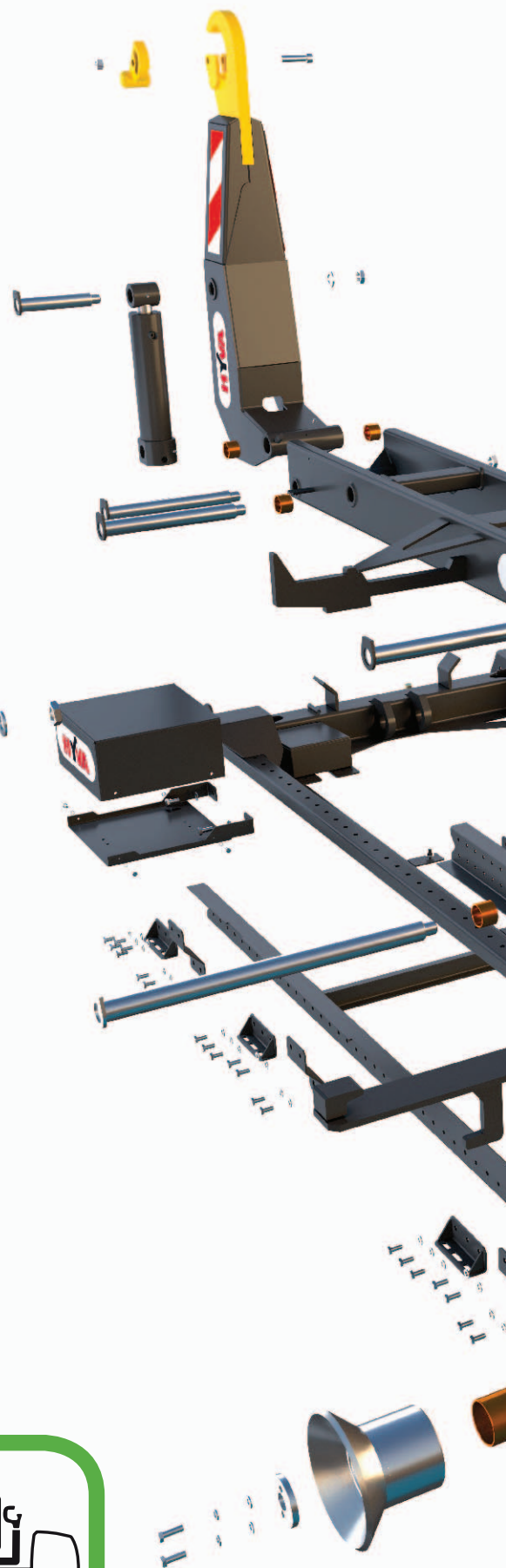





**FACTORY END COAT** Coated in a highly corrosion resistant end coat, the TITAN CITY will stand the test of time. Standard coated in sleek black end coat from the factory. With the option to be coated in any colour, as long as there is a RAL code for it.



**BOLT IT ALL ACCESSORIES** The new TITAN CITY features a line of accessories that can be bolted straight onto the hookloader. No more searching for space on the chassis or leaving out comfort functionalities with a TITAN CITY. The specially designed brackets can hold a wide variety of accessories from toolboxes to fenders.



**VERSATILE** Engineered to be used in a wide range of applications, the TITAN CITY brings versatility to the operator. Whether it is transporting small construction equipment or collecting waste the TITAN CITY supports it all.

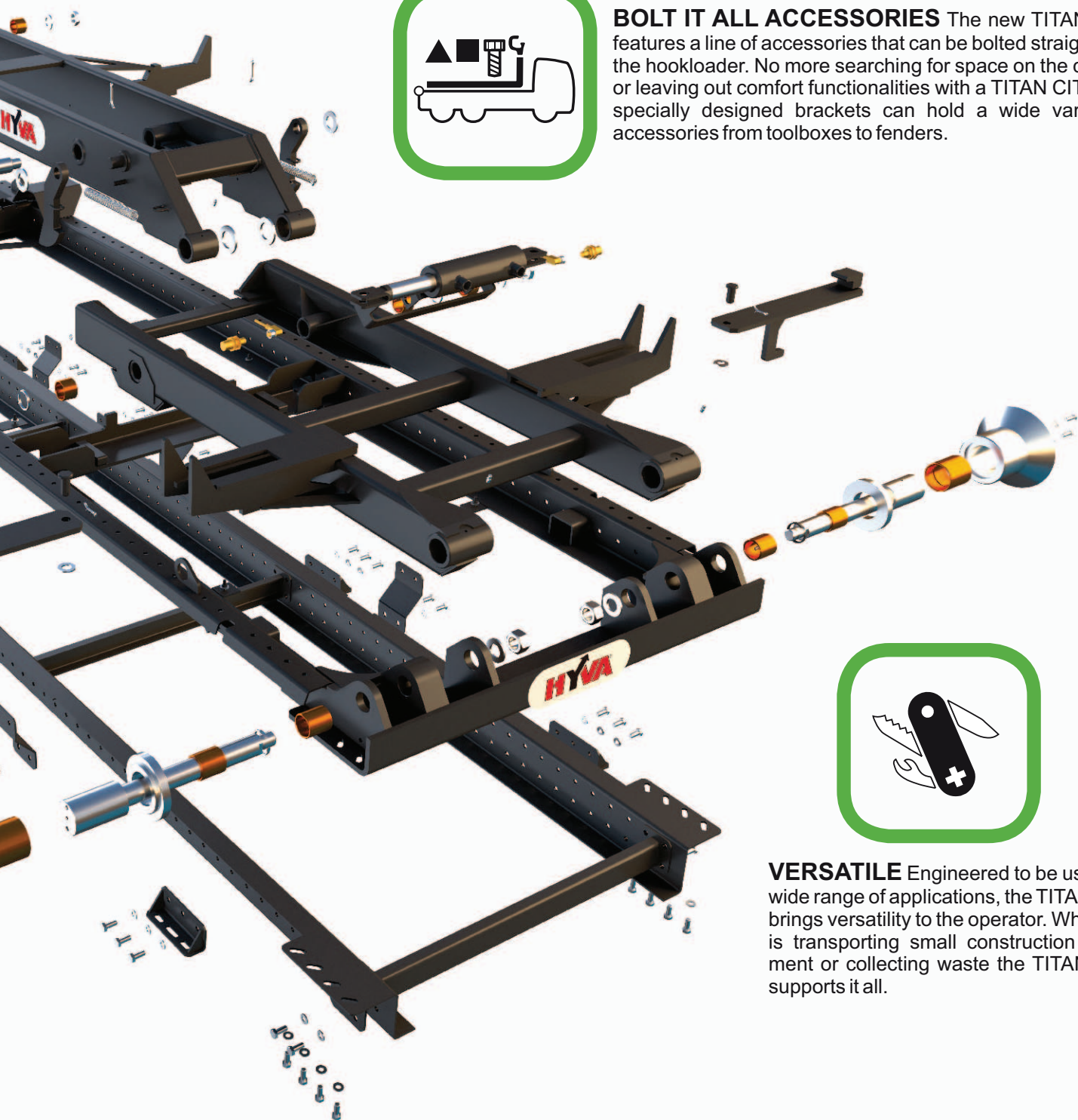





## SEGMENTS FOR CITY HOOKLOADER USE



Fire fighting



Road Works



Waste  
handling



Gardening



Municipality



Building





# HYVA CARE

## Right Up Your Street

Hyva is committed to providing excellent service. With a customer base of 25,000 customers and activity in 130 countries we know how to provide full back up for our customers and dealers.

We have built an international sales and after-sales service network of own subsidiaries, service partners and dealers who have the capability to provide the best transport solutions and provide world class after-sales service through Hyva Care approved service workshops.

Hyva Care starts with a commitment to offering the best possible warranty across our full product range. We also offer customised, low cost repair and maintenance contracts to keep your equipment operating at its optimum and unplanned downtime to the absolute minimum. Operating skiploaders is a hard business conducted in challenging environments.

By reducing unplanned downtime and expenditure to the minimum, Hyva Care makes everything that bit easier.

## Hyva Care – At Your Service.

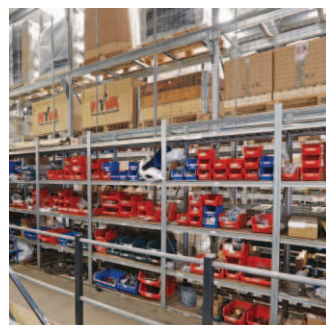

## Key Facts:

- The best warranty in our industry
- Maximum parts availability
- Customised R&M contracts
- Full technical support





Tipping Solutions | Container Handling | Waste Handling | Cranes



FOR SERVICES & PRODUCT INFORMATION VISIT US ONLINE AT

[WWW.HYVA.COM](http://WWW.HYVA.COM)

FOLLOW US AT:



[facebook.com/hyvagroup](https://facebook.com/hyvagroup)



[youtube.com/hyvacorporate](https://youtube.com/hyvacorporate)



[instagram.com/hyvagroup](https://instagram.com/hyvagroup)



[twitter.com/hyvaglobal](https://twitter.com/hyvaglobal)

DEALER STAMP